

# Lamellgardineer Basic

## Vertical blind Basic

Instrukcja | Manual |

89/127 mm

Läs instruktionerna noggrant innan du monterar och använder produkten. Monteringsprocessen kan utföras av en okvalificerad person. Produkt endast för inomhus bruk

Read the instructions carefully before assembling and using the product. Assembling process can be completed by non-professionals. For indoor use only.

### Aktsamhetskrav / WARNING /

Små barn kan kvävas av öglor som skapas av rep, kedjor, dragremmar och fönstersnören. För att undvika hakar och trassling, håll snören och kedjor utom räckhåll för små barn. Linoroach kedjor kan lindas runt barnets hals. Flytta spjälsängar, barnsängar och möbler bort från fönstergardinband. Knyt inte snören. Se till att snören inte trasslar ihop sig och inte bildar öglor.

Young children can be strangled by loops in pull cords, chains, tapes and inner cords that operate the product. To avoid strangulation and entanglement, keep cords out of the reach of young children. Cords may become wrapped around a child's neck. Move beds, cots and furniture away from window covering cords. Do not tie cords together. Make sure cords do not twist and create a loop.

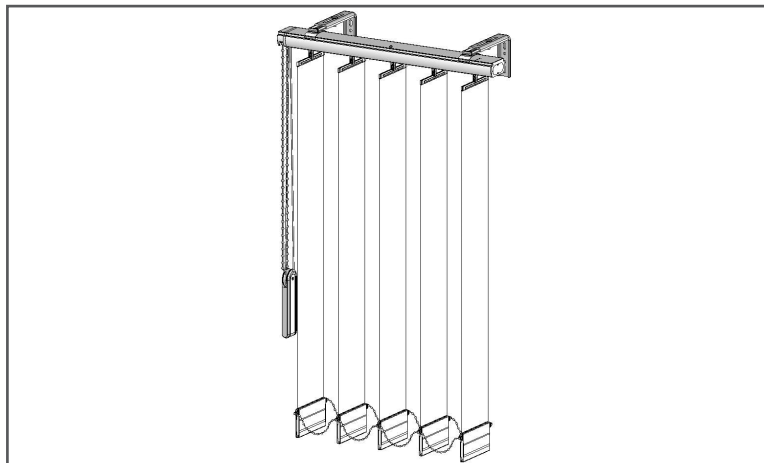
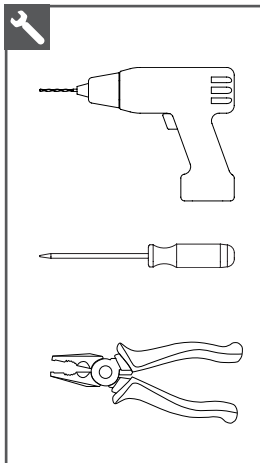
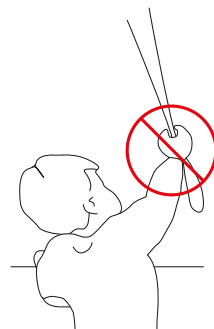

**! UWAGA / ATTENTION /**

Instrukcja przedstawia montaż szyny okrągłej do wieszaka typu klip. Identyczne kroki należy wykonać podczas montażu szyny prostokątnej. Wieszak może być zamontowany bezpośrednio do sufitu jak i do wysięgnika.

Instruction shows montage of the round rail to hanger. For the rectangular rail montage do the same steps. Bracket can be installed to ceiling or to the adjustable extension.

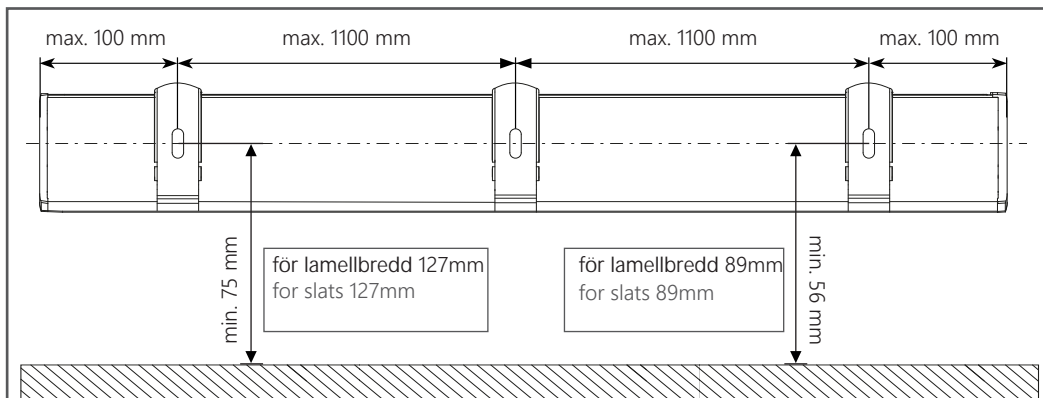

Väggbeslag med längd-justering | Adjustable extension |

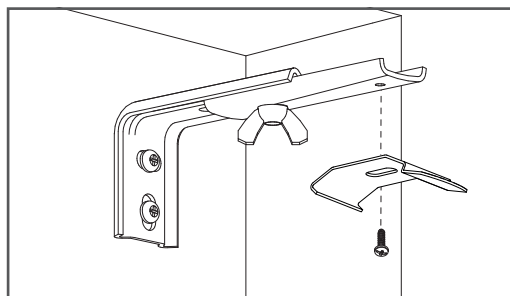
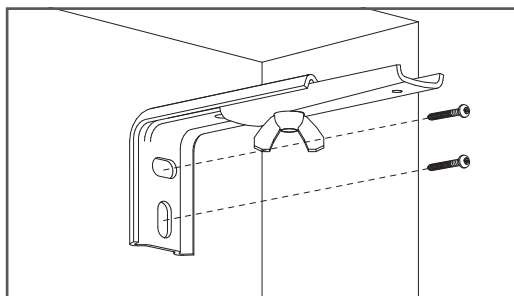

Tak beslag | Bracket clip |

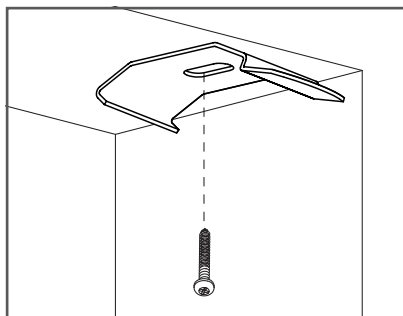

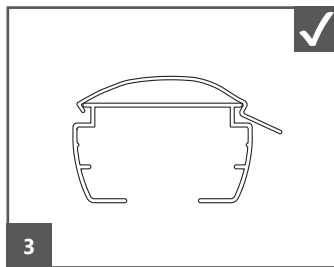
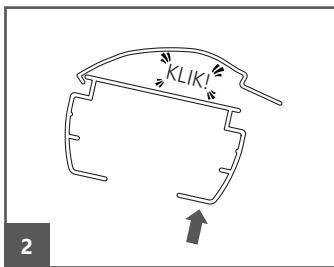
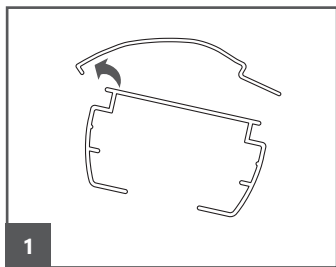

**⚠ VARNING / WARNING /**

Installera säkerhetselementen i enlighet med bifogade BARNSÄKERHETSinstruktioner.  
Install the child safety device as specified in the separate CHILDSAFETY manual.

Lameller | Slats |

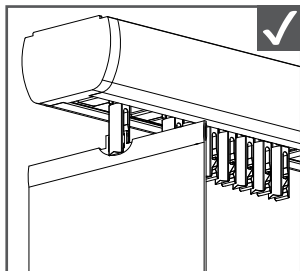
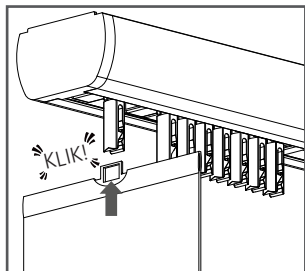

**⚠ Beaktas / ATTENTION /**

PVC-remsor bör installeras med samma steg.  
PVC slats should be installed in the same way.

Botten kedja | Chain |

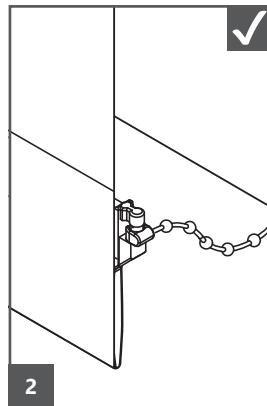
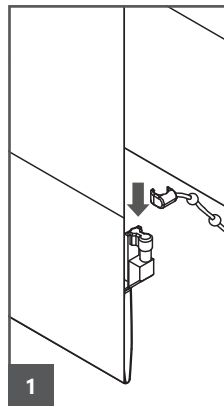
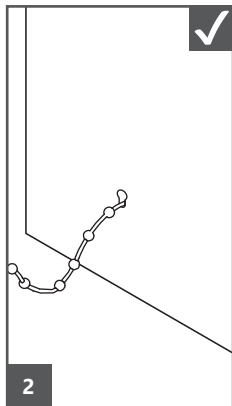
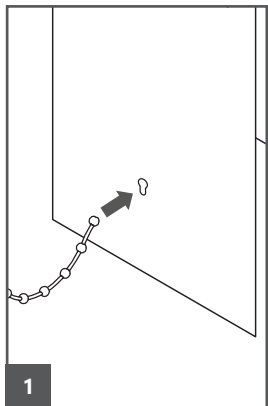

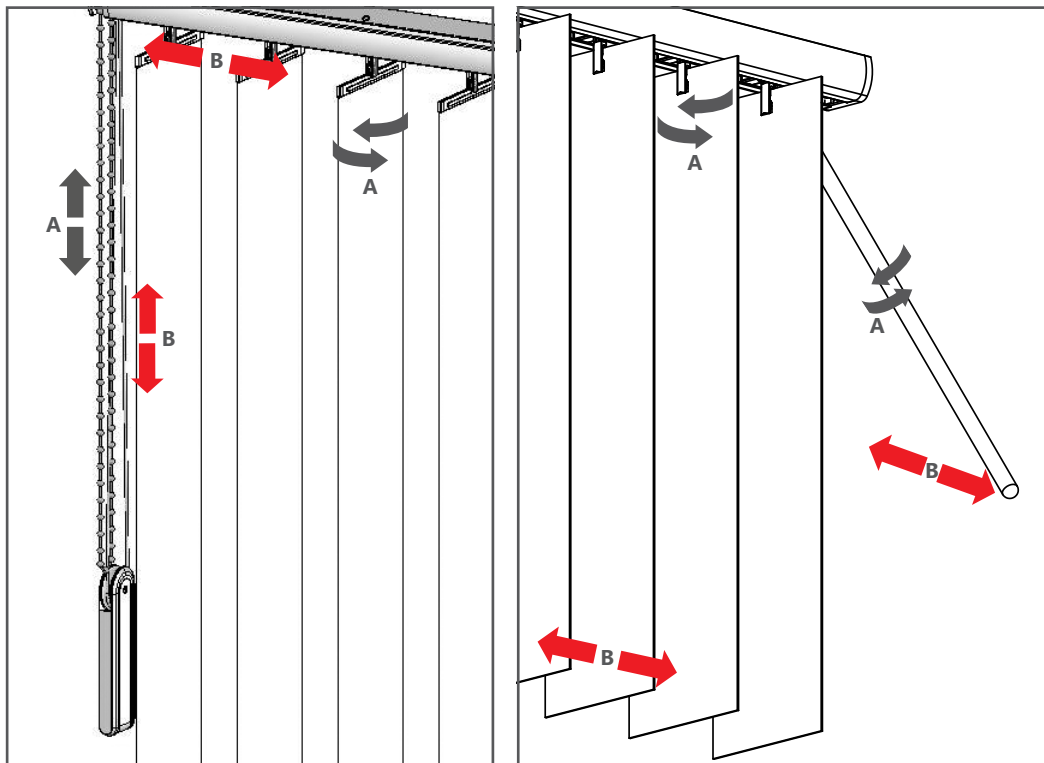

Skötselråd | Maintenance |

Produkten bör torkas regelbundet med en mjuk trasa. Använd inga rengöringsmedel. För att bibehålla produktens effektivitet bör lamellerna flyttas och roteras regelbundet.

The product should be regularly wiped with a soft cloth. Do not use cleaning agents. To keep the product in good working order, the slats should be moved and rounded regularly.

# Tillbehör Child Safety



Child Safety accessories

Child Safety

Instruktion | Manual |

Läs instruktionerna noggrant innan du monterar och använder produkten. Monteringsprocessen kan utföras av en okvalificerad person. Produkt endast för inomhus bruk.

Read the instructions carefully before assembling and using the product. Assembling process can be completed by non-professionals. For indoor use only.

## VARNING / WARNING /

Små barn kan kvävas av öglor som skapas av rep, kedjor, dragremmar och fönstersnören. För att undvika hakar och trassling, förvara sladdar utom räckhåll för små barn. Repen kan lindas runt barnets hals. Flytta spjålsängar, barnsängar och möbler bort från fönstergardinband. Knyt inte snören. Se till att snören inte trasslar ihop sig och inte bildar öglor

Young children can be strangled by loops in pull cords, chains, tapes and inner cords that operate the product. To avoid strangulation and entanglement, keep cords out of the reach of young children. Cords may become wrapped around a child's neck. Move beds, cots and furniture away from window covering cords. Do not tie cords together. Make sure cords do not twist and create a loop.

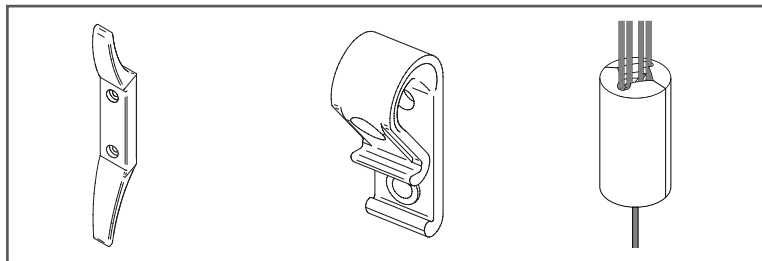
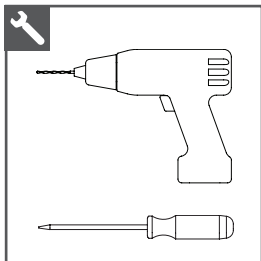
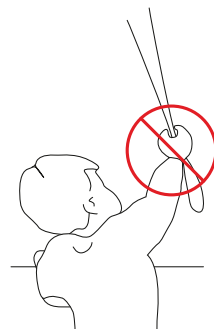

Uchwyt łańcuszka | Chain tensioner

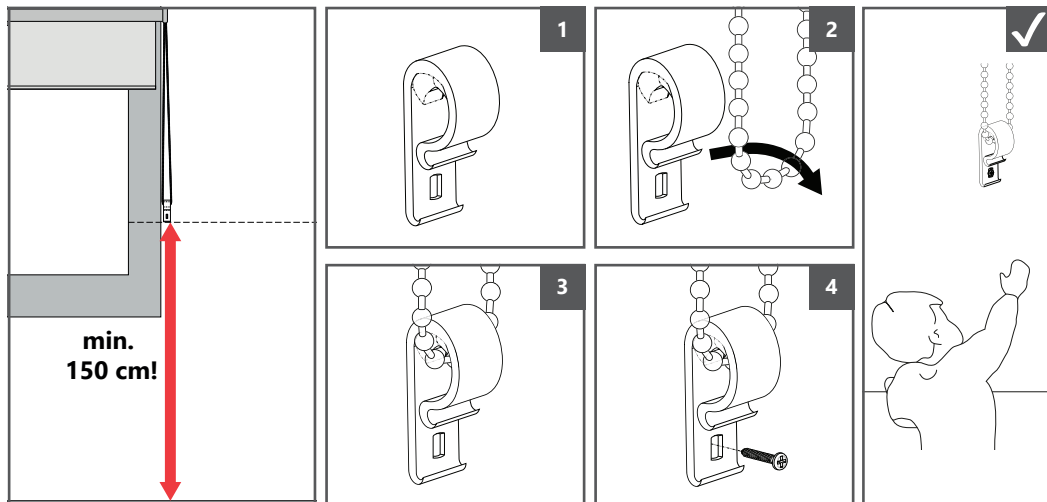

Linhållare | Cord cleat

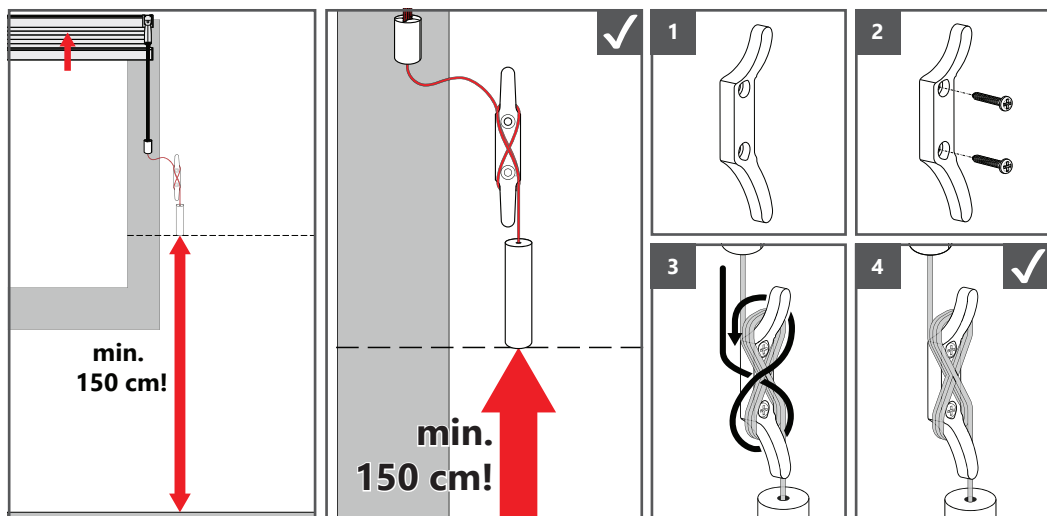

Belastnings lintofs | Break away tassel

